

Drawing(mm)

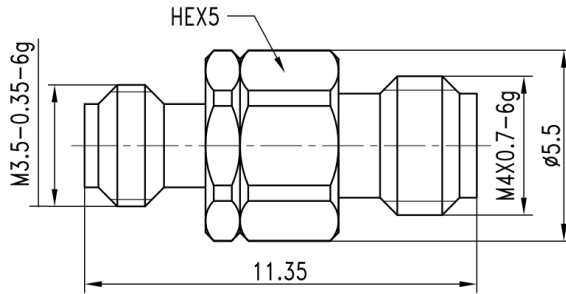

Electrical & Environmental

Impedance	50 ohm
Frequency Range	DC-110 GHz
VSWR	1.35 max
Operating Temp	-55°C to +85°C

Material

Connector Body	Passivated stainless steel
Center Contact	Gold plated beryllium copper
Insulator	PEI

Typical Test Data

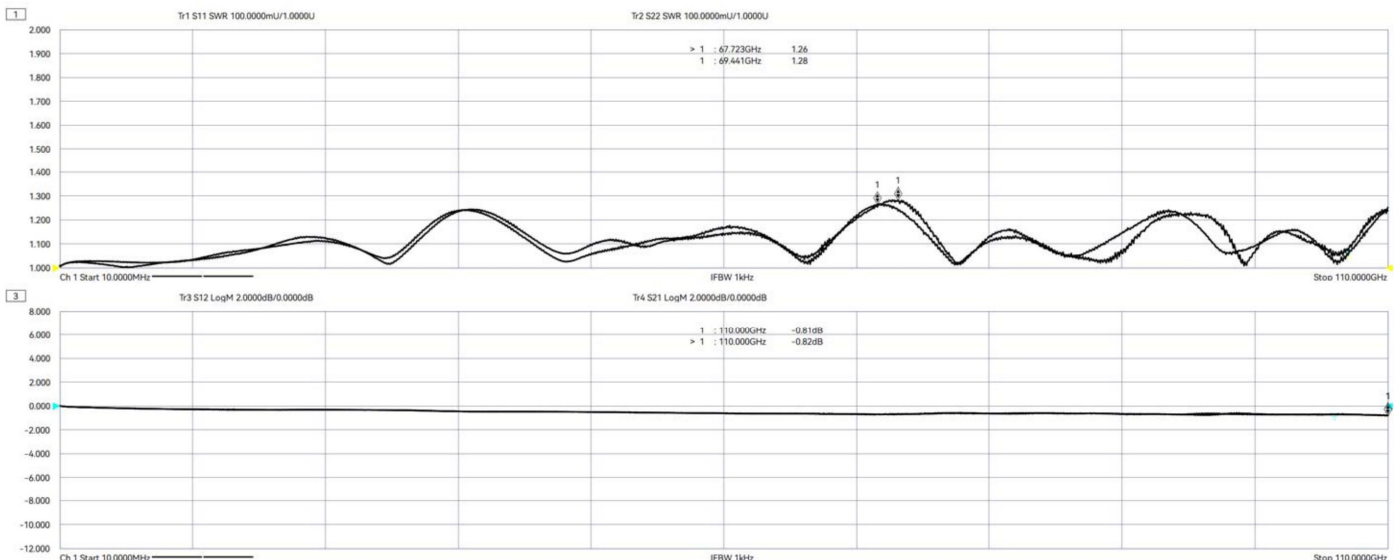

	Sweep Type	Start Freq(GHz)	Stop Freq(GHz)	Sweep Points	IF Bandwidth(Hz)	Sweep Time(s)	Port 1,2Power(dBm)
Ch 1	LIN Freq	0.01	110	1601	1000	1.57903	-5,-5