

# Waveguide to Coaxial Adapter    AWR51SMAA

WR51 to SMA Female, Square Cover Flange, Right Angle



Rev 3

## Electrical

Frequency Range	14.5-22 GHz
VSWR	1.2 max

## Configuration

Waveguide Size	IEC	180
	EIA	WR51
Flange Type	IEC	/
	North America	MIL3922/70-023
Coax Connector	SMA Female	
Body Geometry	Right Angle	

## Materials

Waveguide Body	Aluminum, black or grey painted
Connector Body	Passivated stainless steel
Center Contact	Gold plated beryllium copper

## Mechanical & Environmental

Operating Temp	-40℃ to 70℃
Connector Interface	MIL-STD-348
RoHS	Compliant

## Typical Test Data

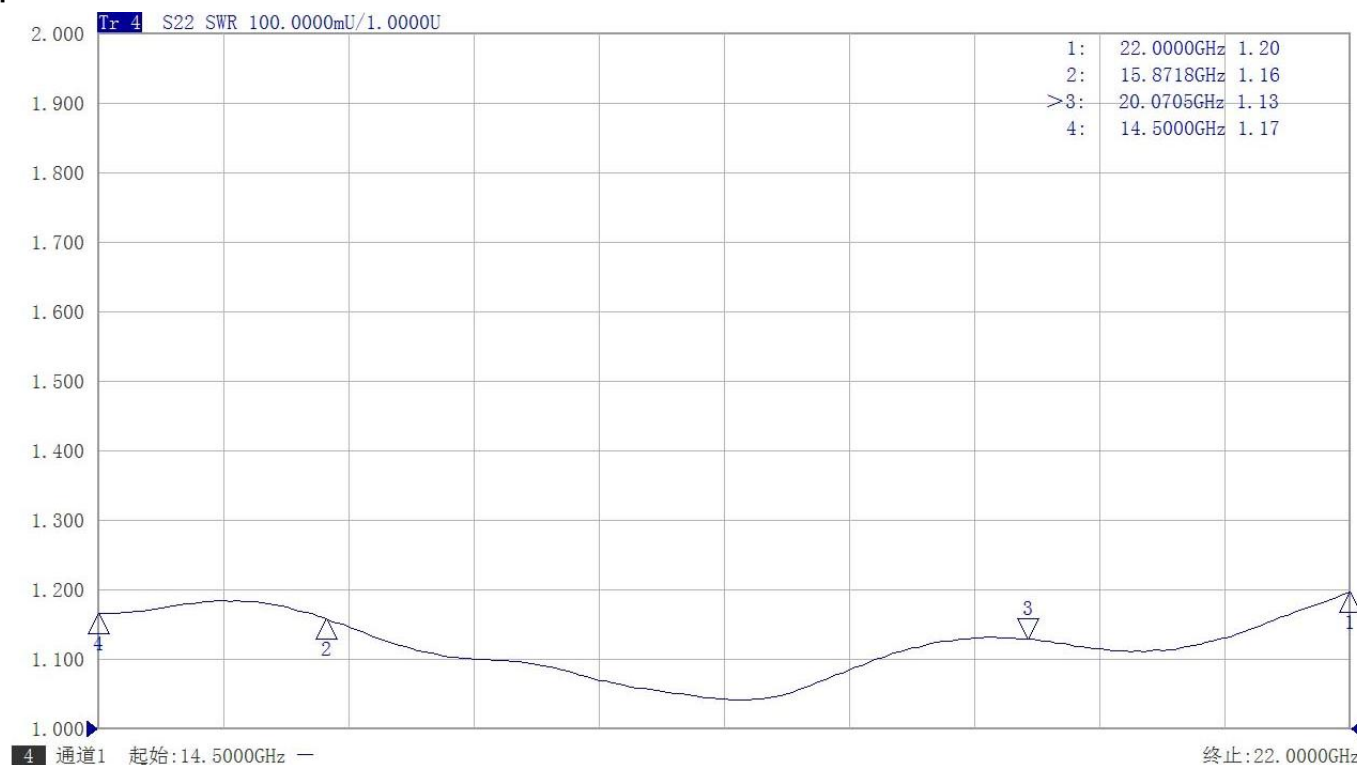

# Waveguide to Coaxial Adapter    AWR51SMAA

WR51 to SMA Female, Square Cover Flange, Right Angle



Rev 3

## Dimensions(mm)

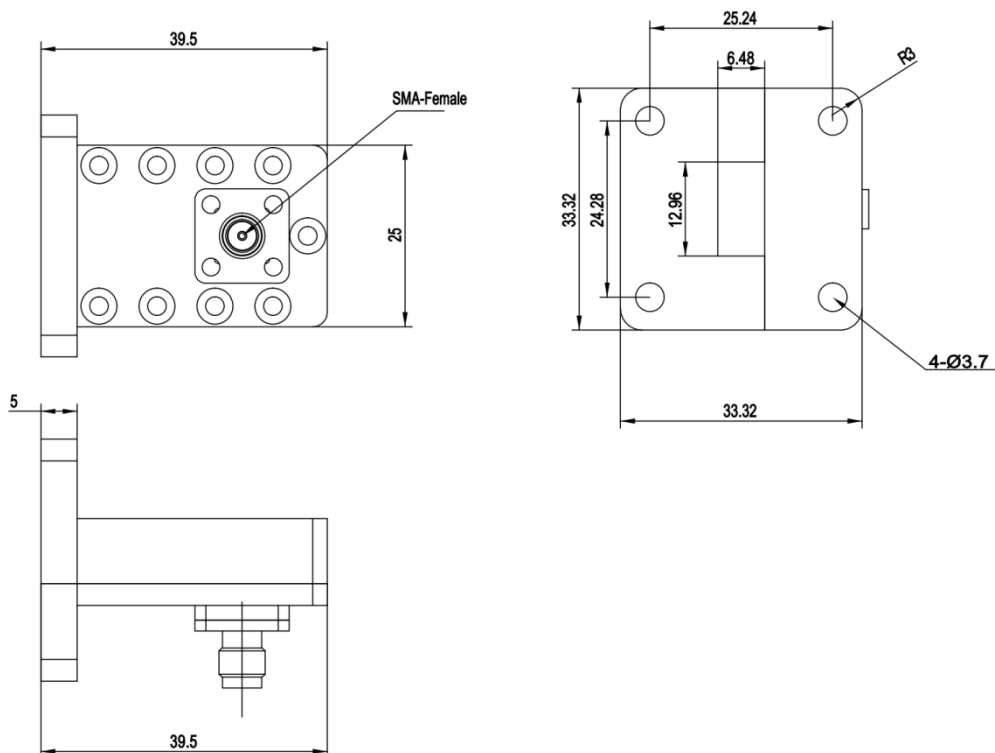

## Flange Comparison (Unit mm)

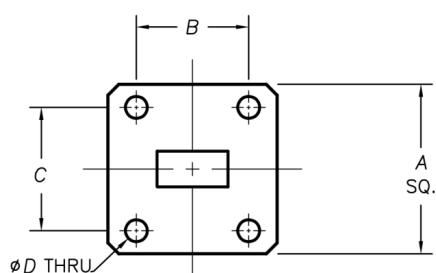

WG SIZE	CONFORMING STANDARD	A	B	C	D
WR51	RF ONE:AWR51SMAA	33.32	24.28	25.24	3.7
	USA:MIL3922/70-023	33.32	24.28	25.24	3.66

\* The purpose of this size comparison is to provide a quick overview of different flange standards.

\* Great care has been given nevertheless there might be a few mistakes.

\* Please check the flange compatibility before ordering. Customized flanges are available.