

Waveguide to Coaxial Adapter **AWR770SMA**

WR770 to SMA Female, Rectangular Cover Flange, Right Angle



Rev 3

Electrical

Frequency Range	0.96-1.46 GHz
VSWR	1.2 max

Configuration

Waveguide Size	IEC	R12
	EIA	WR770
Flange Type	IEC	UDR12
	North America	M3922/76-01 CPR770F
Coax Connector	SMA Female	
Body Geometry	Right Angle	

Materials

Waveguide Body	Aluminum, black or grey painted
Connector Body	Passivated stainless steel
Center Contact	Gold plated beryllium copper

Mechanical & Environmental

Operating Temp	-40°C to 70°C
Connector Interface	MIL-STD-348
RoHS	Compliant

Typical Test Data

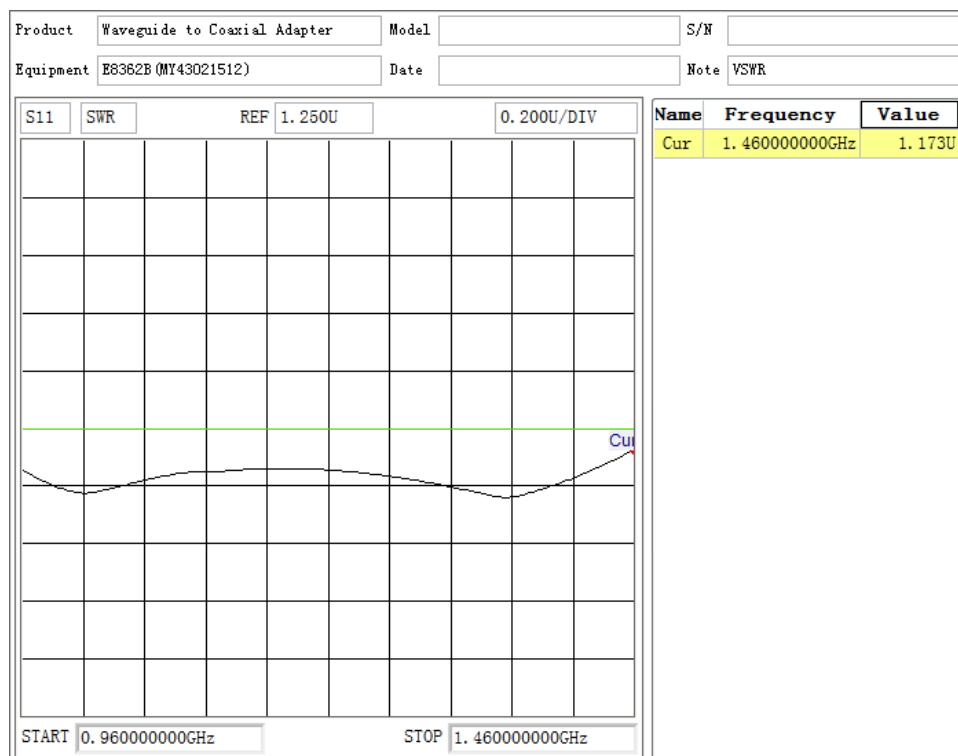

Dimensions(mm)

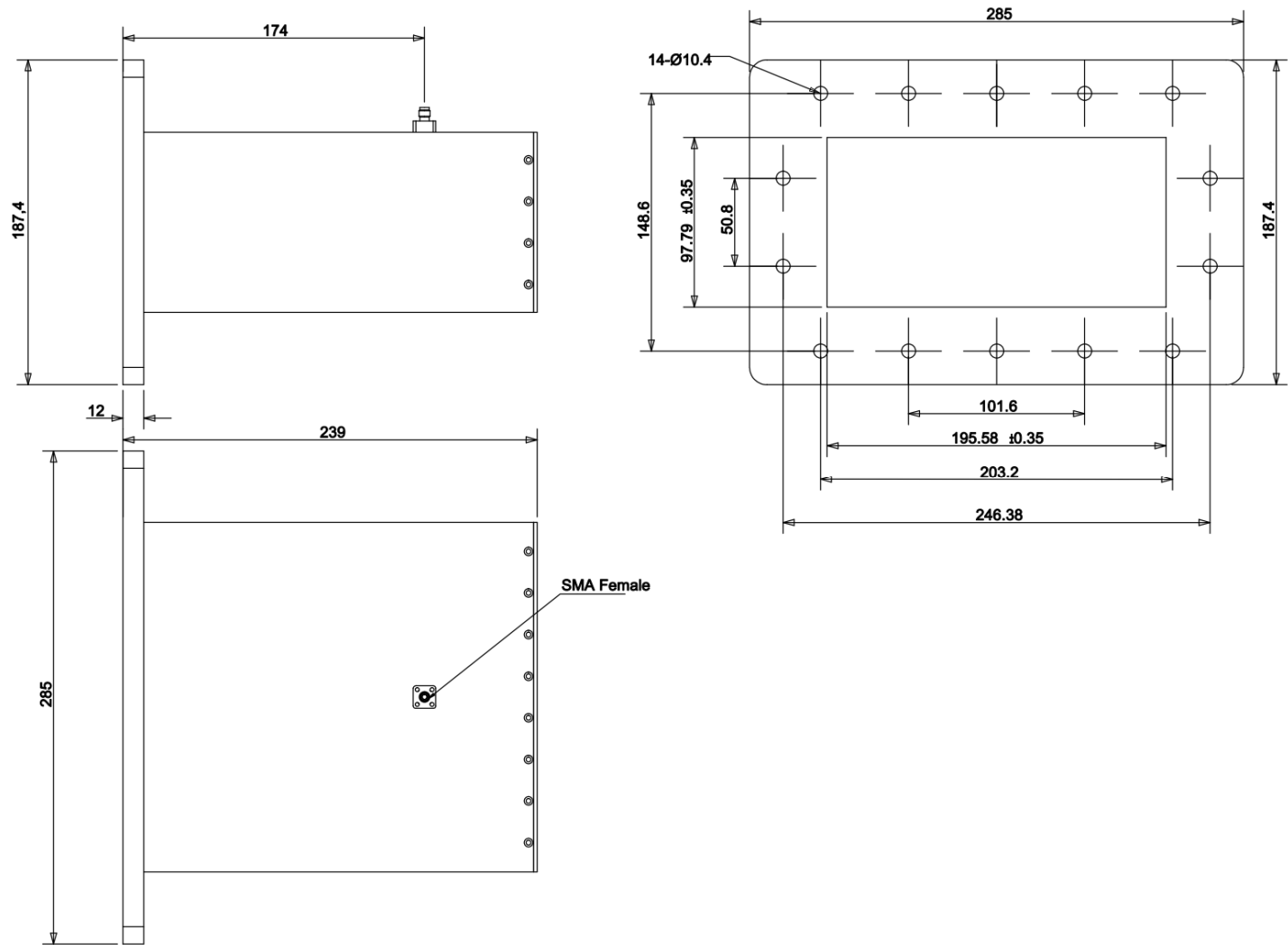

Flange Comparison (Unit mm)

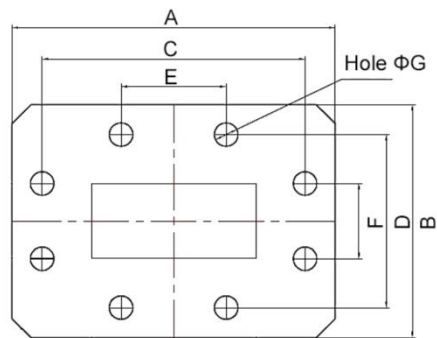

WG SIZE	CONFORMING STANDARD	A	B	C	D	E	F	G
WR770	RF ONE:AWR770SMA	285	187.4	203.2	148.6	101.6	50.8	10.4
	IEC60154:UDR12	285	187.4	203.2	148.6	101.6	50.8	10.4
	USA:M3922/76-01	285	187.4	203.2	148.6	101.6	50.8	10.3
	USA:CPR 770F	285	187.4	203.2	148.6	101.6	50.8	10.3

* The purpose of this size comparison is to provide a quick overview of different flange standards.

* Great care has been given nevertheless there might be a few mistakes.

* Please check the flange compatibility before ordering. Customized flanges are available.