

Waveguide to Coaxial Adapter AWR975D

WR975 to DIN 7/16 Female, Rectangular Cover Flange, Right Angle



Rev 3

Electrical

Frequency Range	0.76-1.15 GHz
VSWR	1.2 max
Average Power	2000 Watts

Configuration

Waveguide Size	IEC	R9
	EIA	WR975
Flange Type	IEC	UDR9
	North America	M3922/76-02 CPR975F
Coax Connector	DIN Female	
Body Geometry	Right Angle	

Materials

Waveguide Body	Aluminum, black or grey painted
Connector Body	Ternary alloy plated brass
Center Contact	Silver plated beryllium copper

Mechanical & Environmental

Operating Temp	-40°C to 70°C
Connector Interface	IEC-61169
RoHS	Compliant

Typical Test Data

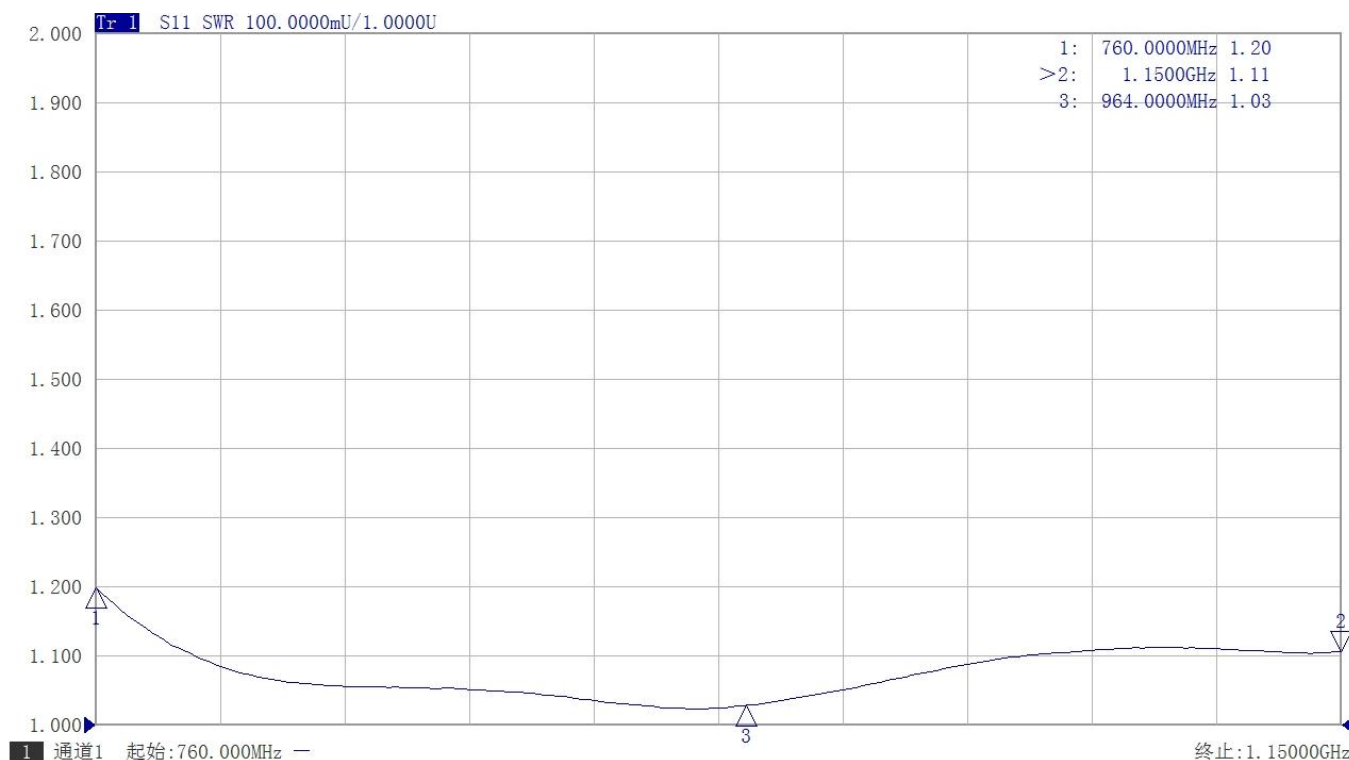

Dimensions(mm)

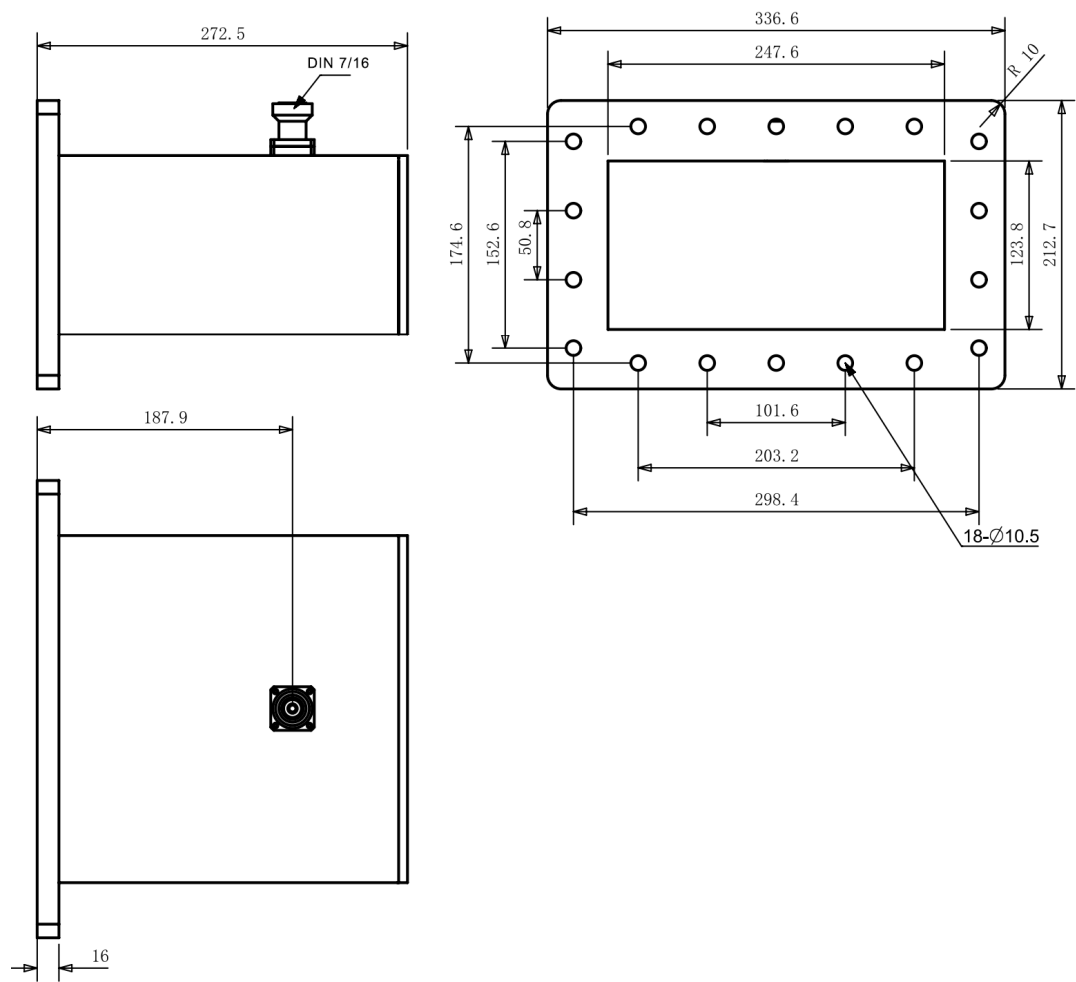

Flange Comparison (Unit mm)

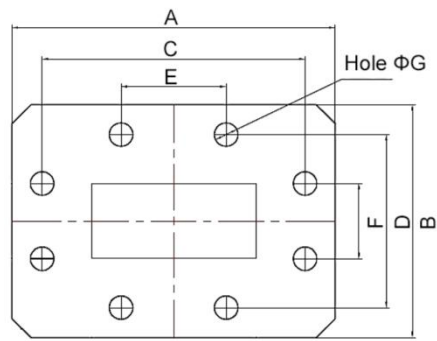

WG SIZE	CONFORMING STANDARD	A	B	C	D	E	F	G
WR975	RF ONE:AWR975D	336.6	212.7	298.44	174.6	101.6	50.8	10.5
	IEC60154:UDR9	336.6	212.7	298.44	174.6	101.6	50.8	10.4
	USA:M3922/76-02	336.6	212.7	298.44	174.6	101.6	50.8	10.3
	USA:CPR 975F	336.6	212.7	298.44	174.6	101.6	50.8	10.3

* The purpose of this size comparison is to provide a quick overview of different flange standards.

* Great care has been given nevertheless there might be a few mistakes.

* Please check the flange compatibility before ordering. Customized flanges are available.