



### Electrical

<b>Impedance</b>	50 ohm		
<b>Frequency Range</b>	DC-18 GHz		
<b>VSWR</b>	1.35 max		
<b>Input Avg Power</b>	2W@ 25°C ambient, derating linearly to 0.5W at 100°C		
<b>Peak Power</b>	20W (5 micro-sec pulse width, 1% duty cycle)		
<b>Direction</b>	Bidirectional, SMP female to SMP male (Full detent)		

<b>Attenuation(dB)</b>	1-10	20	30
<b>Accuracy(dB)</b>	-0.6/+0.6	-0.8/+0.8	-1.0/+1.0

### Mechanical

<b>Connector Body</b>	Passivated stainless steel for male & Gold plated BeCu for female
<b>Center Contact</b>	Gold plated BeCu/brass
<b>Net Weight</b>	About 5 g

### Environmental

<b>Operating Temperature</b>	-55°C to 100°C
<b>Storage Temperature</b>	-55°C to 125°C
<b>RoHS</b>	Compliant
<b>Temperature Coefficient</b>	<0.0004 dB/dB/°C

### Dimensions(mm)

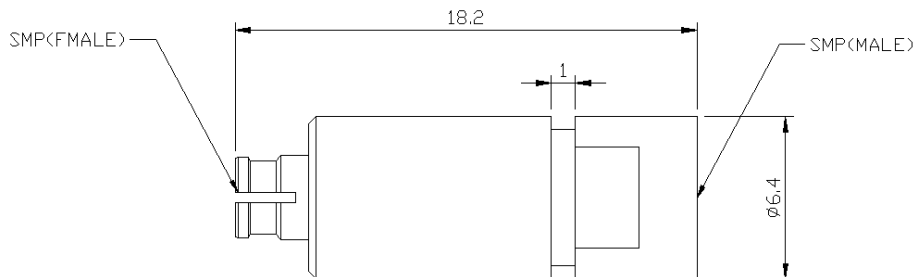

### Notes

- SMP male limited detent available.  
Change model to RA18PL-XX

### Model Description

#### RA18P-XX

1.XX for dB value: 06=6dB,30=30dB