



Electrical

Impedance	50 ohm				
Frequency Range	DC-18 GHz				
VSWR	1.45 max				
Input Avg Power	150W@ 25℃ ambient, derating linearly to 15W at 100℃				
Peak Power	5kW (5 micro-sec pulse width, 1% duty cycle)				
Direction	Unidirectional, N male input, N female output (other configurations available)				
Attenuation(dB)	6-10	20	30	40	50,60
Accuracy(dB)	±2.0	±1.8	±1.5	±1.3	±1.4

Mechanical

Connector Body	Passivated stainless steel
Heat Sink	Black anodized aluminum
Center Contact	Gold plated beryllium copper/brass
Net Weight	About 1000 g

Environmental

Operating Temperature	-55℃ to 100℃
Storage Temperature	-55℃ to 125℃
RoHS	Compliant
Temperature Coefficient	<0.0004 dB/dB/℃

Dimensions(mm)

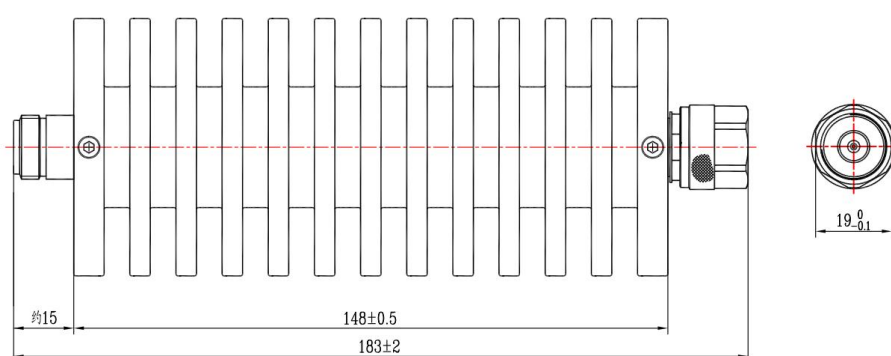
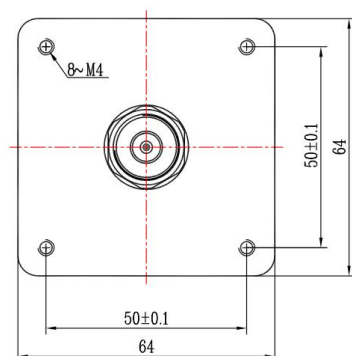

Notes

- 1.Always pay attention to the direction of attenuators.
- 2.To maintain best performance, recommended to use fan to keep the case temperature under 85℃.
- 3.Customized dB values, outlines and optimal accuracy/VSWR available.

Model Description

RFH18XXND150-S

- 1.XX for dB value: 06=6dB,30=30dB
- 2.Code for connector configuration:
A=female for two ends; B=male for two ends
C=female for input and male for output;
D=male for input and female for output.