



#### Electrical

Impedance	50 ohm			
Frequency Range	DC-50 GHz			
VSWR	1.38 max			
Input Avg Power	30W@ 25°C ambient, derating linearly to 3W at 100°C			
Peak Power	100W (5 micro-sec pulse width, 10% duty cycle)			
Direction	Unidirectional, 2.4mm male input, 2.4mm female output (other configurations available)			
Attenuation(dB)	10	20	30	40
Accuracy(dB)	-2.2/+2.5	-1.8/+2.0	-1.8/+2.0	-1.8/+2.0

#### Mechanical

Connector Body	Passivated stainless steel
Heat Sink	Black anodized aluminum
Center Contact	1.27um Gold plated BeCu
Net Weight	Approx 130 g

#### Environmental

Operating Temperature	-55°C to 100°C
Storage Temperature	-55°C to 125°C
RoHS	Compliant
Temperature Coefficient	<0.0004 dB/dB/°C

#### Dimensions(mm)

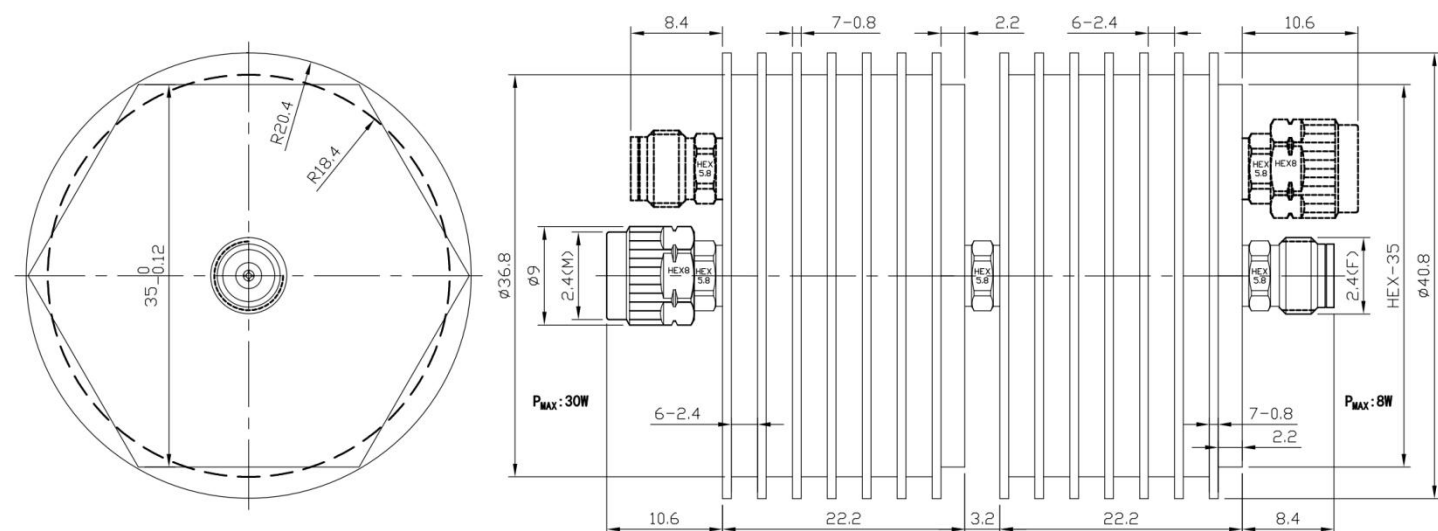

#### Notes

- 1.Always pay attention to the direction of attenuators.
- 2.To maintain best performance, recommended to use fan to keep the case temperature under 85°C.
- 3.Customized dB values, outlines and optimal accuracy/VSWR available.

#### Model Description

##### RFH50XX24D30

- 1.XX for dB value: 06=6dB,30=30dB
- 2.Code for connector configuration:  
A=female for two ends; B=male for two ends  
C=female for input and male for output;  
D=male for input and female for output.

