

Coaxial Fixed Attenuator

RFHB06XX4310C2

DC-6 GHz, 1-30 dB, 2 Watts, 4.3-10, Bidirectional



Rev 1

Electrical

Impedance	50 ohm			
Frequency Range	DC-6 GHz			
VSWR	1.2 max			
Input Avg Power	2W@ 25℃ ambient, derating linearly to 0.2W at 100℃			
Peak Power	250W (5 micro-sec pulse width, 0.4% duty cycle)			
Direction	Bidirectional, 4.3-10 female to 4.3-10 male (other configurations available)			
Attenuation(dB)	1-6	7-10	11-20	21-30
Accuracy(dB)	±0.3	±0.5	±0.6	±0.8

Mechanical

Connector Body	Ternary alloy plated brass
Heat Sink	N/A
Center Contact	Gold plated beryllium copper/brass
Net Weight	About 60 g

Environmental

Operating Temperature	-55℃ to 100℃
Storage Temperature	-55℃ to 125℃
RoHS	Compliant
Temperature Coefficient	<0.0004 dB/dB/℃

Dimensions(mm)

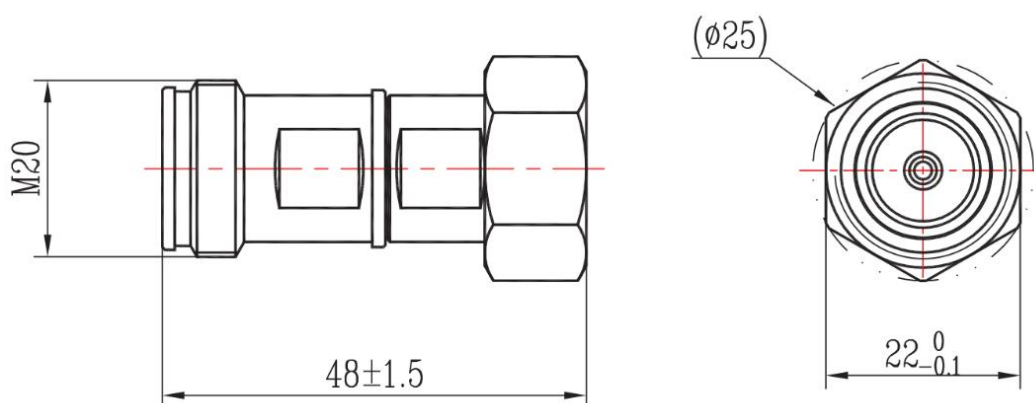

Notes

1.Customized dB values, outlines and optimal accuracy/VSWR available.

Model Description

RFHB06XX4310C2

1.XX for dB value: 06=6dB,30=30dB

2.Code for connector configuration:

A=female for two ends; B=male for two ends

C=female for one end and male for the other.