



Waveguide Crossguide Directional Coupler

WDCT34-40

40dB, WR34, 21.7-33 GHz, UBR320 Square Cover Flange, WR34 Coupled Port

Rev 1

Electrical

Frequency Range	21.7-33 GHz
VSWR	1.10 max(Main line), 1.25 max (Secondary line)
Coupling	40 ± 1.5 dB
Directivity	15 dB min
Operating Temperature	-40 °C ~ +70 °C

Mechanical

Waveguide Size	WR34(R260)
Flange Type	UBR260
Flange Material	Aluminum, Conductive oxidation
Body Material and Plating	Aluminum, Painted
Coupled Port	WR34
Net Weight	Approx 75g

Dimensions(mm)

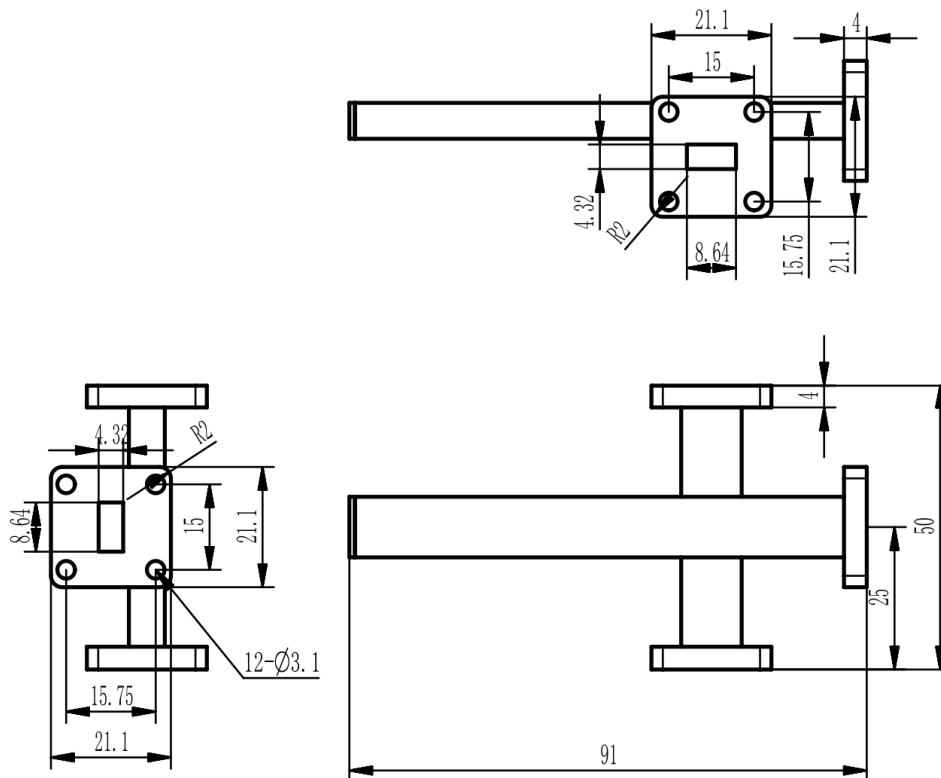



Waveguide Crossguide Directional Coupler

WDCT34-40

40dB, WR34, 21.7-33 GHz, UBR320 Square Cover Flange, WR34 Coupled Port

Rev 1

Typical Test Data

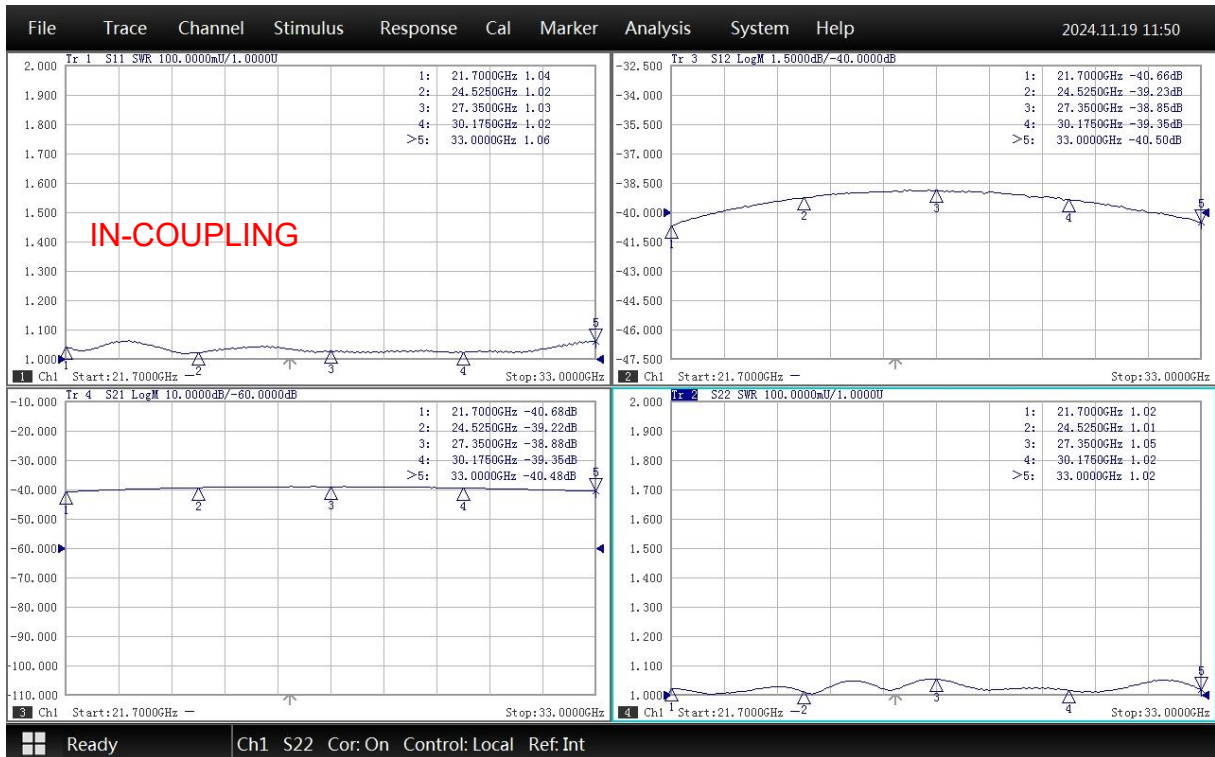
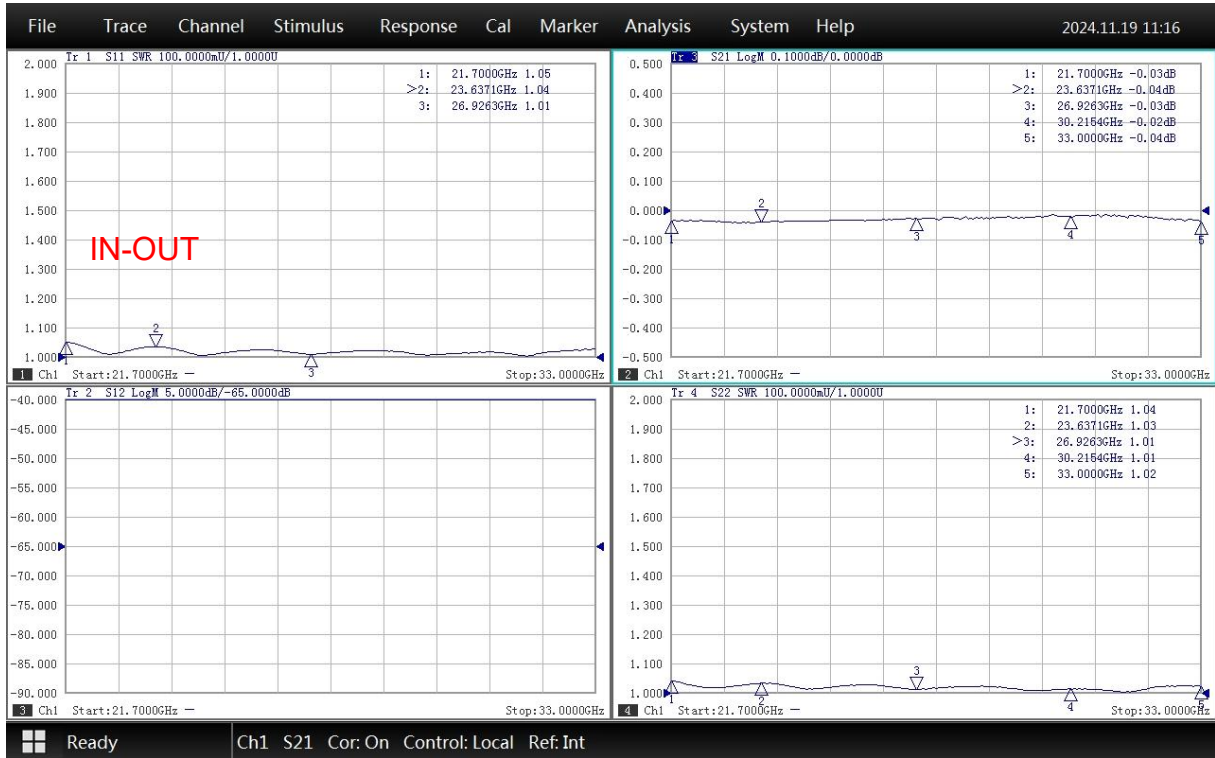



Waveguide Crossguide Directional Coupler

WDCT34-40

40dB, WR34, 21.7-33 GHz, UBR320 Square Cover Flange, WR34 Coupled Port

Rev 1

