

# Waveguide Termination

# WT42A



WR42, 17.6-26.7 GHz, 0.5 Watts, Square Cover Flange

Rev 2

## Electrical

Frequency Range	17.6-26.7 GHz
VSWR	1.05 max
Input Avg Power	0.5 Watts @ 25°C
Operating Temperature	-40°C ~ +70°C

## Mechanical

Waveguide Size	WR42(R220)
Flange Type	IEC: UBR220
Waveguide Material	Copper
Waveguide Finish	Grey painted

## Dimensions(mm)

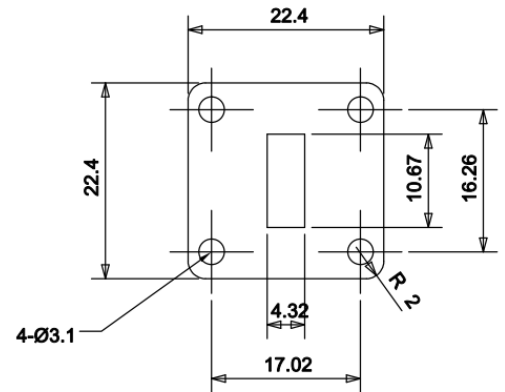
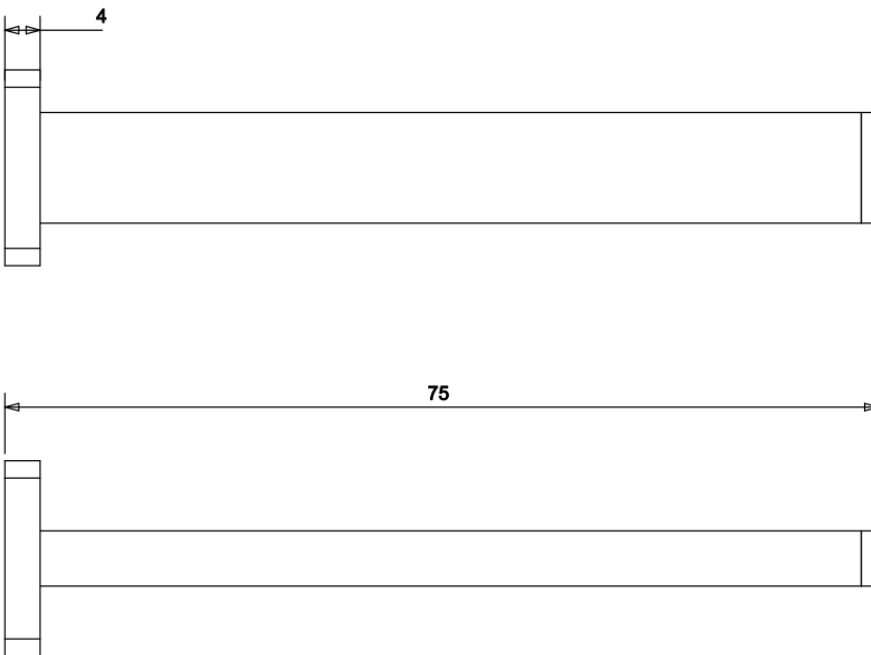



### Typical Test Data

