

Waveguide Termination

WT62A100

W62, 12-18 GHz, 100 Watts, Square Cover Flange

Rev 1

Electrical

Impedance	50 ohm
Frequency Range	12-18 GHz
VSWR	1.15 max
Input Avg Power	100 Watts @ 25°C
Peak Power	1k Watts
Operating Temperature	-40°C~+70°C

Mechanical

Waveguide Size	WR62(R140)
Flange Type	IEC: UBR140
Waveguide Material	Aluminum
Waveguide Finish	Black painted
Heat Sink Material	Aluminum
Heat Sink Finish	Black painted

Dimensions(mm)

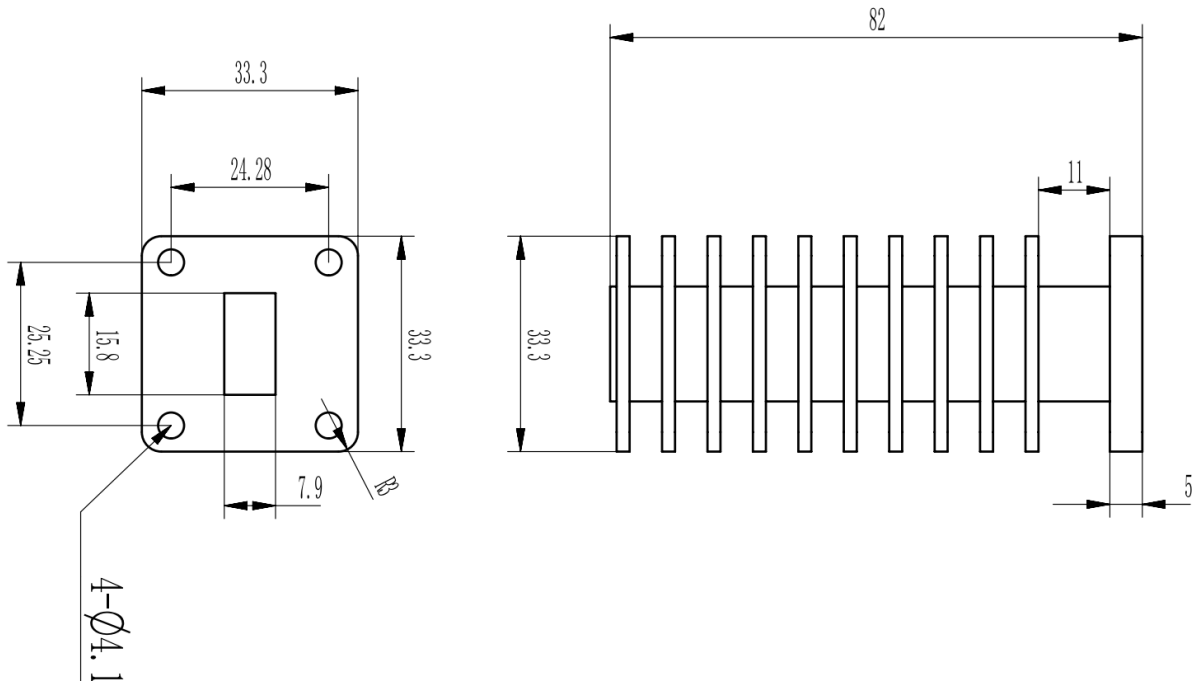



Waveguide Termination

WT62A100

W62, 12-18 GHz, 100 Watts, Square Cover Flange

Rev 1

Typical Test Data

